

Boligtype 5.3

Adresse: Robinievej 11, 39

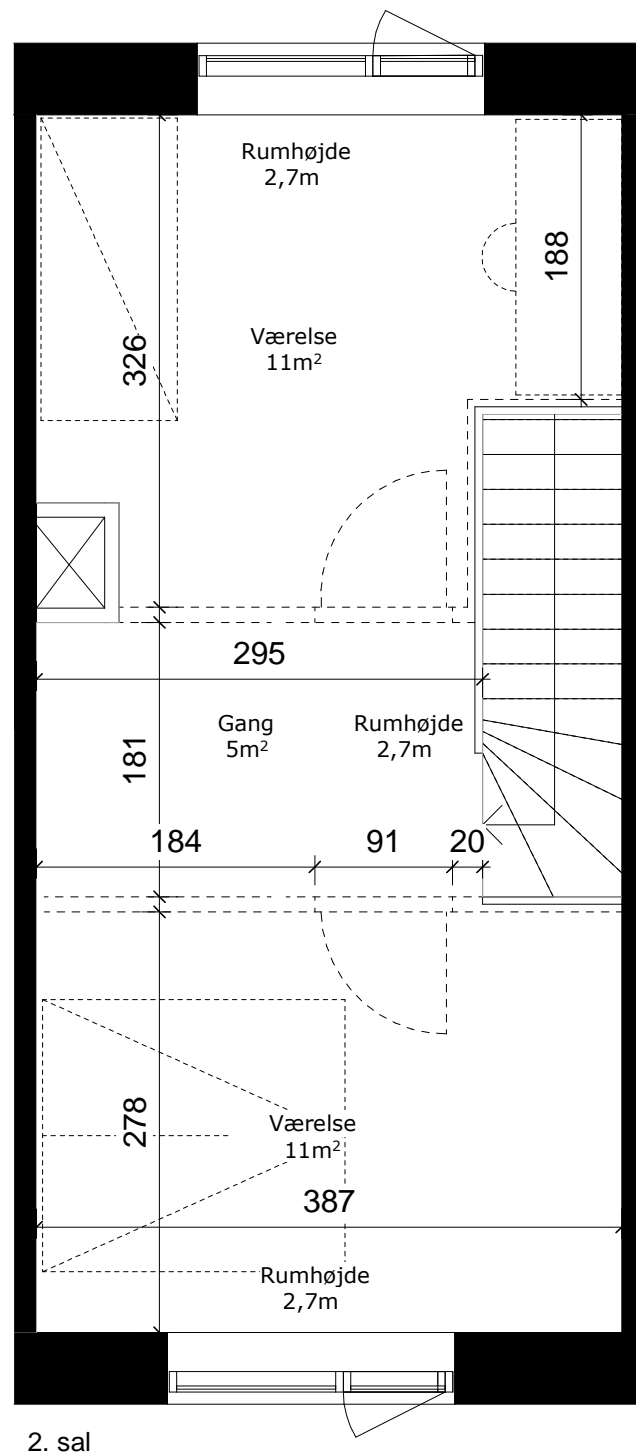

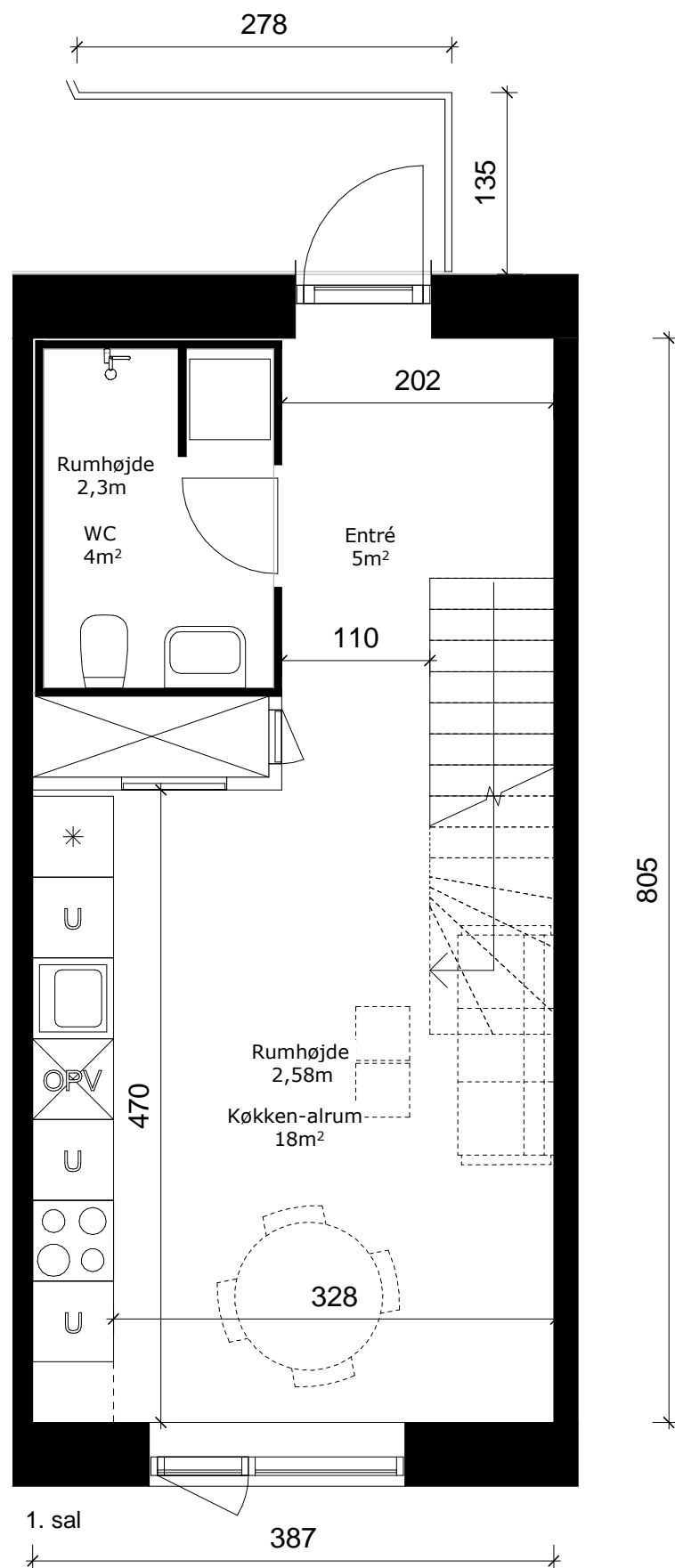











Boligen består af to rum på 1. og 2. sal.
På 2. sal er der mulighed for at etablere 2 rum.
Adgang til boligen sker via udvendig trappe og repos.

Bruttoareal: 84m²

Nettoareal: 63m²

(Nettoareal er det reelle boligareal inkl. indvendig trappe, skillevægge og installationskakt)

Målsætning er angivet i centimeter.
Rumhøjder er det enkelte rums gns. højde
Boligarealer er vejledende

-  Ovn, komfur og emhætte
-  Køkkenvask + vaskeskab
-  Køle- og fryseskab
-  FORBEREDT for opvaskemaskine
-  Underskab
-  Disponibelt rum
-  Toilet
-  Håndvask
-  Bruseniche
-  FORBEREDT for vaskemaskine og kondensørretumbler
-  Mulighed for skillevægge
-  Teknik- og installationskakt